

Vegetable Slicer Multigreen Vegetable Cutter - 2,5 liters

ITEM # _____

MODEL # _____

NAME # _____

SIS # _____

AIA # _____

603843 (MUGY)

Combined unit with vegetable hopper and cutter + ejector and 4 plates. Speed of rotation 1500 rpm

Short Form Specification

Item No. _____

Combi machine equipped with a "Fresh Cut" and Cutter equipment with all the parts in contact with food removable and dw safe. Vegetables are fed directly into the half moon loading hopper where a piston presses the vegetables against the stainless steel cutting discs. The loading of long shaped vegetables is through the special cylindrical opening in the piston itself. The bowl, twin blade rotor and cover, fitted directly onto the drive shaft in place of the "Fresh Cut" equipment, are used for chopping and mixing condiments and sauces. 1 speed: 1500rpm. Transparent cover with magnetic safety device. Supplied with: "Fresh Cut" hopper with safety lever, ejector and 4 cutting discs (slicing disc 2 and 3mm, shredding disc 2 mm and disc for julienne 2mm) and Cutter equipment: plastic bowl, transparent cover and smooth twin blade rotor.

Main Features

- Combi machine equipped with a "Fresh Cut" and Cutter equipment with all the parts in contact with food removable and dishwasher safe.
- Delivered with:
 - 3 liter cutter bowl in plastic with smooth edge "S" blade included
 - All plastic vegetable prep attachment with a half moon hopper and a cylindrical hopper
 - 4 discs included: TD2 2mm slicing disc, TD3 3mm slicing disc, RD2 2mm grating disc, ED2 2mm shredding disc
- Vegetable attachment designed for slicing, shredding and grating; cutter mixer for chopping, mixing, mincing and blending.
- Round (long vegetables) and half moon feed hoppers.
- Continuous feed model.
- Automatic restart of the machine with the half-moon lever in position.
- Red OFF, green ON buttons.
- Magnetic safety system and motor brake. Prevents machine from running when lever swings away or is open.
- Complete selection of stainless steel blades available (diam. 175 mm).
- Capacity:
 - vegetable slicer productivity up to 250 kg/h, up to 200 meals per service
 - cutter mixer working capacity up to 1 kg, for 10-50 meals per service

Construction

- Power: 370 watts.
- 1 speed: 1500 rpm plate speed.
- All polycarbonate plastic hopper and housing.
- Compact and portable design.

APPROVAL: _____

Included Accessories

- 1 of Cutter equipment (plastic bowl, lid and rotor) for Multigreen PNC 653145
- 1 of Stainless steel shredding disc 2 mm (dia. 175 mm) PNC 653171
- 1 of Stainless steel slicing disc 2 mm (dia. 175 mm) PNC 653176
- 1 of Stainless steel slicing disc 3 mm (dia. 175 mm) PNC 653177
- 1 of Stainless steel grating disc 2 mm (dia. 175 mm) PNC 653178
- 1 of Fresh cut hopper with safety lever PNC 653770

Optional Accessories

- Microtooth blade rotor for 2,5 lt cutter mixer PNC 650035
- Stainless steel slicing disc 5mm (dia. 175mm) PNC 653001
- Stainless steel slicing disc 7mm (dia. 175mm) PNC 653002
- Stainless steel grating disc 3mm (dia. 175mm) PNC 653003
- Stainless steel grating disc 4mm (dia. 175mm) PNC 653004
- Stainless steel grating disc 7mm (dia. 175mm) PNC 653005
- Stainless steel shredding disc 4mm (dia. 175mm) PNC 653006
- Stainless steel disc with corrugated blades 2mm (dia. 175mm) PNC 653007
- Cutter equipment (stainless steel bowl, lid and rotor) for K25 and Multigreen PNC 653047
- Storage box for 1 disc (dia. 175 mm and 205 mm) PNC 653050
- Cutter equipment (plastic bowl, lid and rotor) for Multigreen PNC 653145
- Smooth blade rotor for 2,5 lt cutter mixer PNC 653146
- Stainless steel shredding disc 2 mm (dia. 175 mm) PNC 653171
- Stainless steel slicing disc 2 mm (dia. 175 mm) PNC 653176
- Stainless steel slicing disc 3 mm (dia. 175 mm) PNC 653177
- Stainless steel grating disc 2 mm (dia. 175 mm) PNC 653178
- Stainless steel bowl for 2,5 lt cutter mixer PNC 653487
- Plastic bowl for 2,5 lt cutter mixer PNC 653488
- Transparent lid for cutters (K25 and Multigreen) PNC 653512
- Snack Pack - set stainless steel discs (TD2-2mm slicing disc, TD5-5mm slicing disc, RD2-2mm grating disc) PNC 653535
- Fresh cut hopper with safety lever PNC 653770

Front

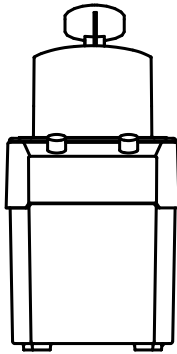

Side

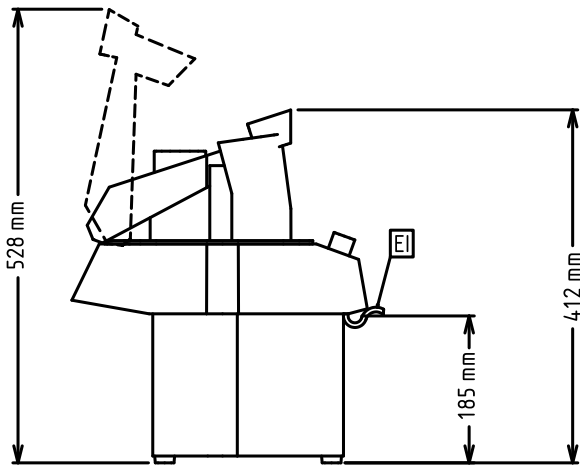

EI = Electrical inlet (power)

Top

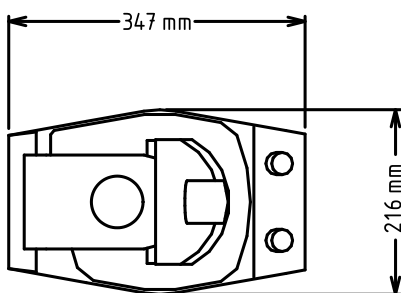
Electric

Supply voltage:

603843 (MUGY) 220-240 V/1N ph/50 Hz

Electrical power max.: 0.37 kW

Total Watts: 0.37 kW

Capacity:

Performance (up to): 250 - kg/hour

Capacity: 2.5 litres

Key Information:

External dimensions, Width: 216 mm

External dimensions, Height: 412 mm

External dimensions, Depth: 347 mm

Shipping weight: 16 kg